



Location Finders International, Inc.
 9440 Enterprise Dr, Mokena, IL 60448
 (708) 390-1629

1034 Warren Ave.
 Downers Grove, IL

Medical Office Space Available

7,756 sq

MARKET SUMMARY

- Steps away from Main Street Metra station - 2,500 passenger's per day
- 1 mile south from Downers Grove North High School - over 2,000 students
- Less than 1.5 miles from Advocate Good Samaritan
- Terrific demographics of 250,000 people with incomes of \$94,000 within 5-miles

DEMOGRAPHICS

POPULATION	1 Mile	14,058
	3 Mile	97,836
	5 Mile	256,060
# HOUSEHOLDS	1 Mile	5,721
	3 Mile	38,847
	5 Mile	102,583
MEDIAN HH INCOME	1 Mile	\$115,895
	3 Mile	\$97,848
	5 Mile	\$94,901

CONTACT

SHANE FORDE
 sforde@lfirealestate.com
 (708) 390-1625
ALAN ERICKSON
 aerrickson@lfirealestate.com
 (708) 390-1629

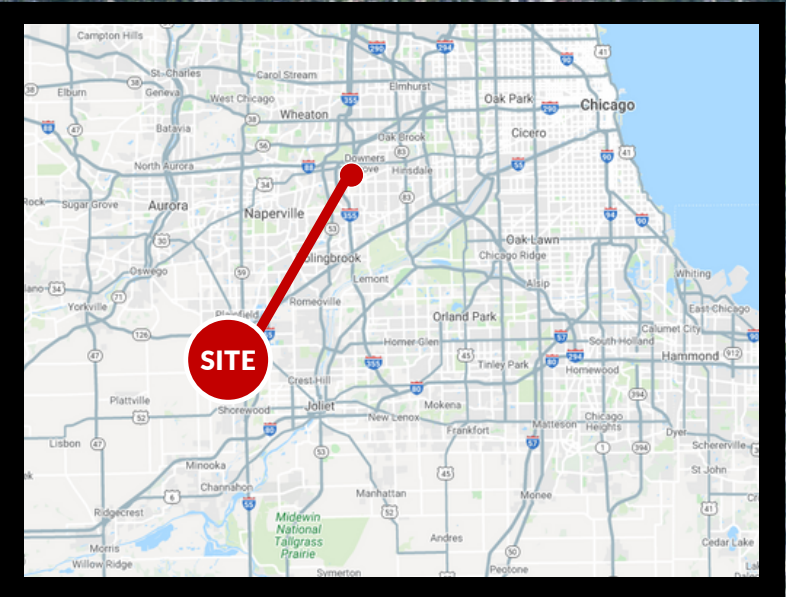
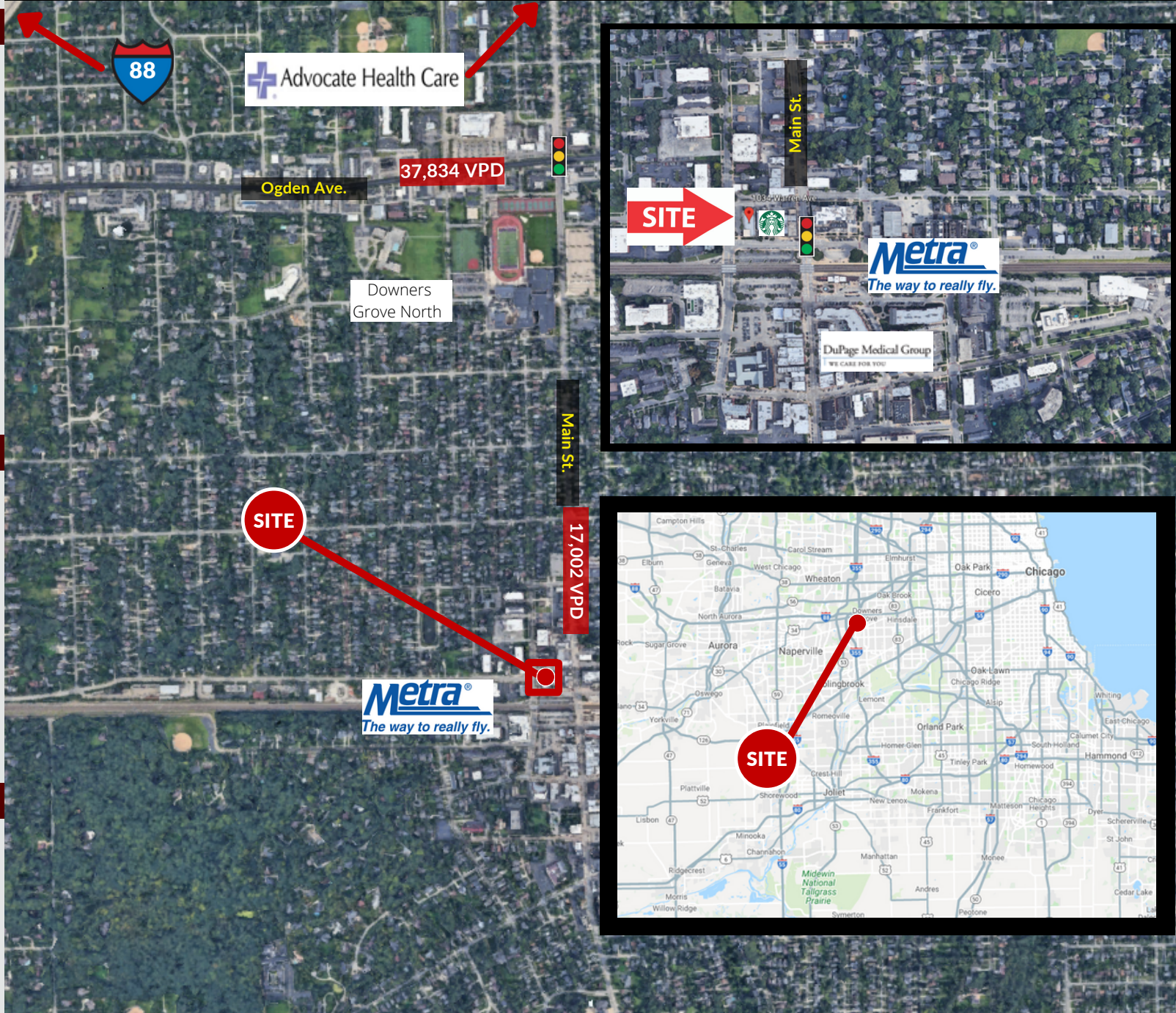

Medical Office Space Available

7,756 sq

SITE SUMMARY

- 7,756 square feet of Medical Office
- Room Breakdown: 16 Exam Rooms, 4 Offices, 1 lab, 1 X-ray
- Signage visible from street
- All exams rooms are full furnished including sink
- On-site parking with ample street parking
- Many potential practice layouts

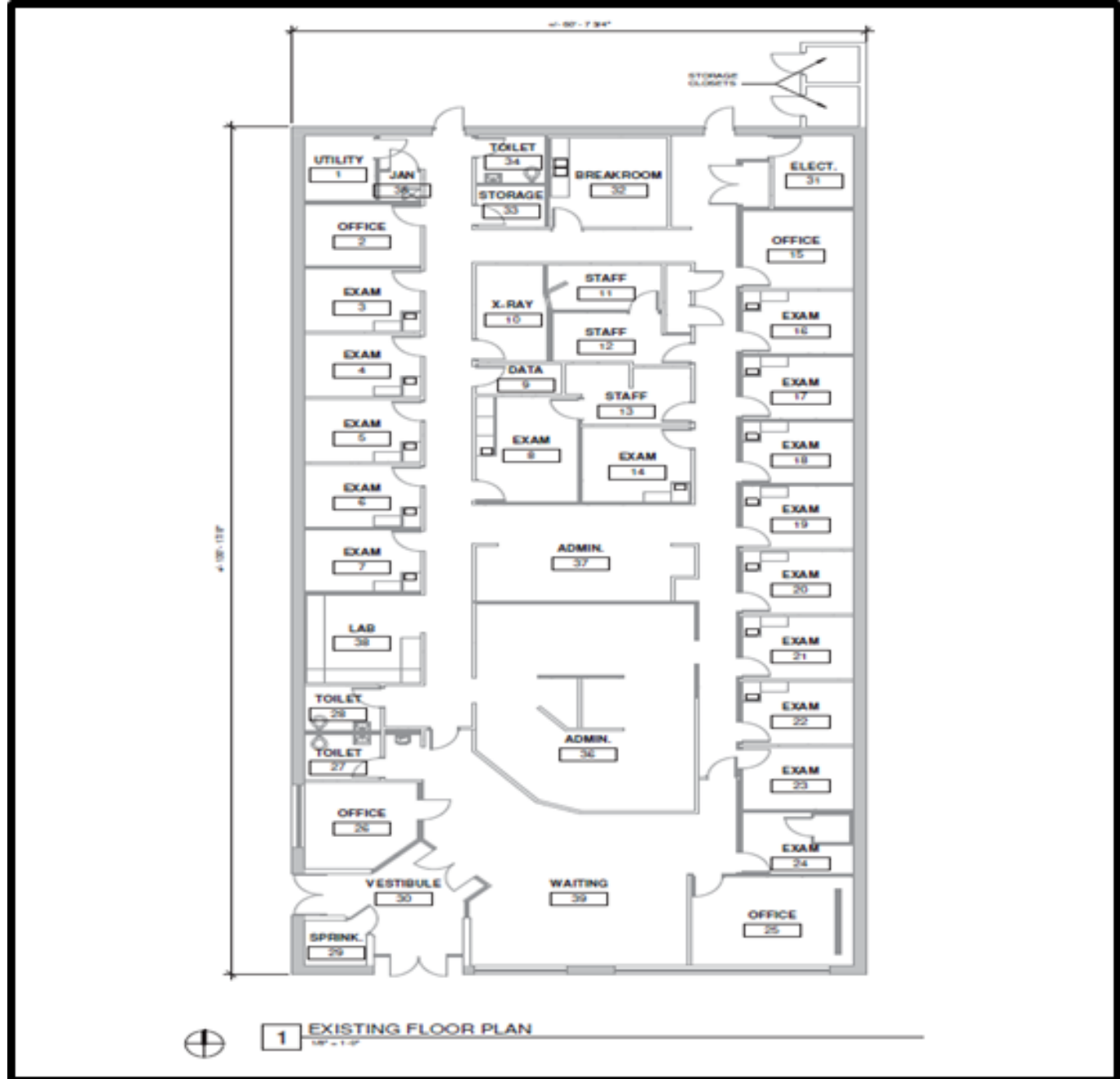

CONTACT

SHANE FORDE
 sforde@lfirealestate.com
 (708) 390-1625

ALAN ERICKSON
 aerickson@lfirealestate.com
 (708) 390-1629