



Location Finders International, Inc.  
9440 Enterprise Dr, Mokena, IL 60448  
(708) 390-1629

**13211 – 13229 S. Cicero**  
Crestwood, IL

## Retail Space Available

**1,480 sf**

### MARKET SUMMARY

- Site is located at front door of the Crestwood retail market and 1 mile south of the full interchange at I-294 & 127th St
- High visibility at a busy intersection with strong surrounding retail area
- Additional area retailers include: Walmart, Menards, Target, Kohl's, Ross, TJ Maxx and many more
- Serves high density communities of Crestwood, Midlothian, and Oak Forest
- High daytime population within trade area

### DEMOGRAPHICS

POPULATION	1 Mile	12,042
	3 Mile	93,649
	5 Mile	301,885
# HOUSEHOLDS	1 Mile	4,177
	3 Mile	33,518
	5 Mile	116,103
MEDIAN HH INCOME	1 Mile	\$66,013
	3 Mile	\$69,833
	5 Mile	\$74,059

### CONTACT

#### ALAN ERICKSON

aerickson@lfirealestate.com  
(708) 390-1629





Location Finders International, Inc.  
9440 Enterprise Dr, Mokena, IL 60448  
(708) 390-1629

**13211 – 13229 S. Cicero**  
Crestwood, IL

## Retail Space Available

**1,480 sf**

### SITE SUMMARY

- **Building GLA:** 13,628 SF
- **Available:** 1,480 SF Built-Out Restaurant
- **Parking:** 47 shared parking spaces
- **Signage:** Shared signage on Cicero available
- **Access:** Two full access points off Cicero;  
Two full access points off Cal Sag; Cross  
access with Raising Cane's and existing  
multi-tenant building.
- **Traffic Counts:**
  - 42,400 VPD on Cicero Ave.
  - 13,700 VPD on Cal Sag.

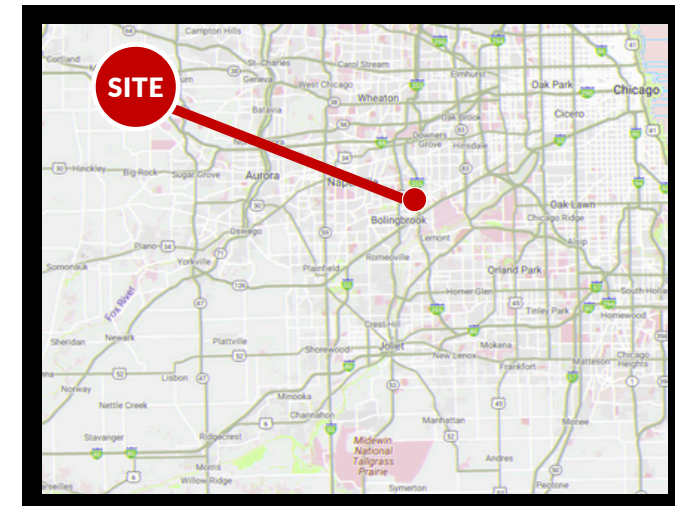
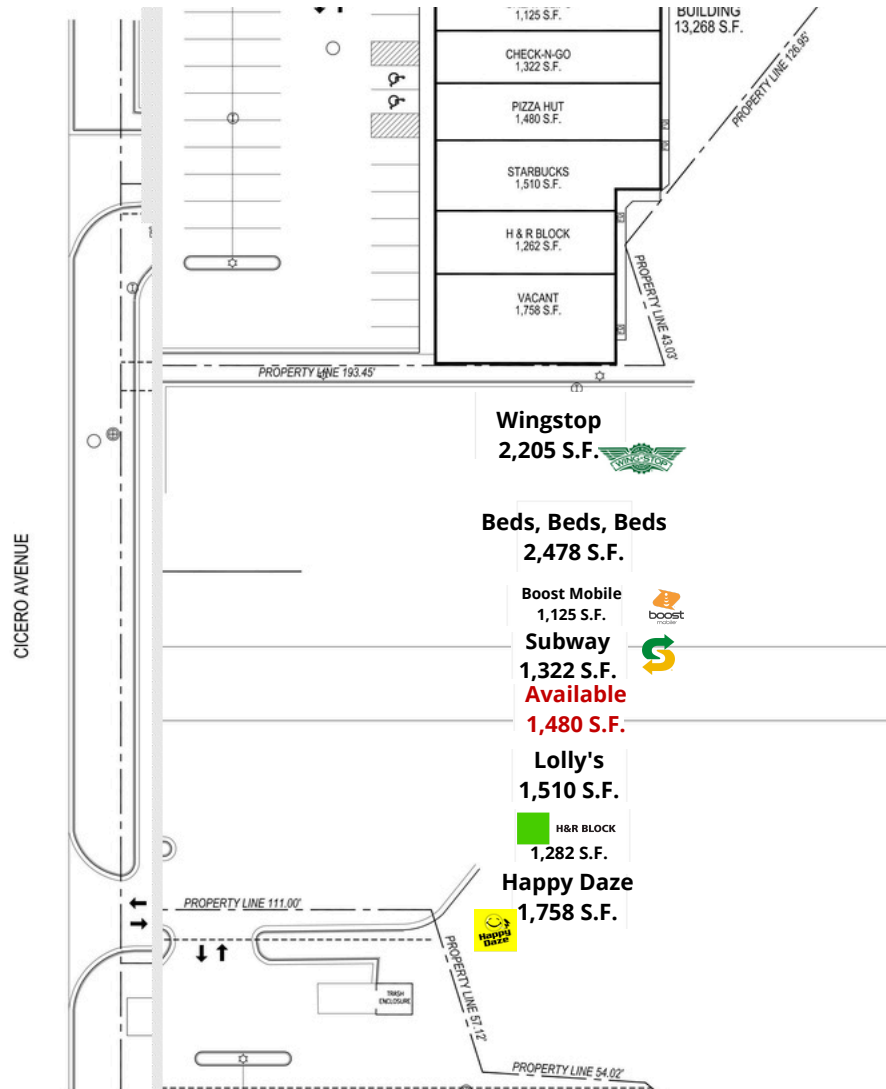

### CONTACT

**ALAN ERICKSON**  
aerickson@lfirealestate.com  
(708) 390-1629